

DIRECTOR | EXPLORER 5" LOUDSPEAKERS



D55EX



DBA5EX

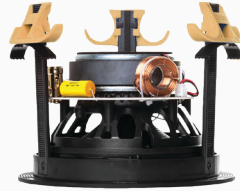

SPECIFICATIONS

SPECIFICATIONS	D55EX & DBA5EX
Cutout Diameter	5 7/8" (149mm)
Speaker Diameter	6 13/16" (172mm)
Grille Diameter	7 3/16" (183mm)
Grille Depth	3/16" (5mm)

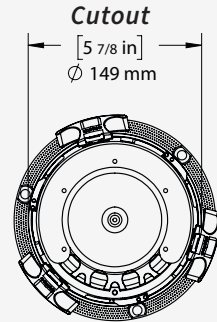

SILICONE SEALANT: Care should be taken to **COMPLETELY SEAL THE RUBBERIZED OUTSIDE EDGE** of the speaker, to the **PLASTIC INNER EDGE** of the Bayonet Ring. Apply a liberal bead of Marine Grade Silicone along the inside edge of the Bayonet Ring, then insert the speaker. This will improve weather resistance and also assure that mechanical vibrations, like those common in watercraft, will not dislodge the loudspeaker.

Note: *The final visible silicone layer must be flattened to not exceed 1mm, so it does not interfere with the Grille Install.*

Scan the QR Code at the bottom of page for full instructions for this product.

Please visit docs.originacoustics.com or scan this QR code using your smart device for the most up to date safety information and use instructions for this product.



**All warranties and warranty conditions are subject to change. Please refer to docs.originacoustics.com for the latest information.*

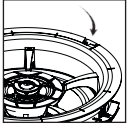

The Speaker will arrive securely in its Bayonet Ring. Scan the QR Code on the reverse of this page for full instructions for this product.

REMOVAL OF SPEAKER FROM BAYONET RING

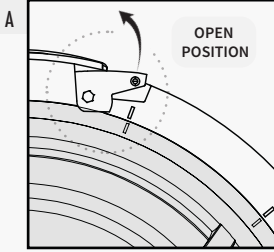

OPEN POSITION: PULL THE METAL LOCK TAB AWAY from the Bayonet Ring, before removing loudspeaker from Bayonet Ring.

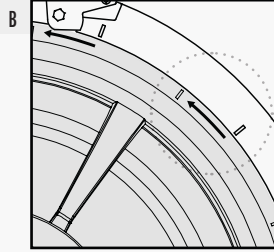

With one hand on the ring & one on the speaker, **ONE QUARTER TURN COUNTER-CLOCKWISE** will release the Speaker from the Bayonet Ring.

SPEAKER INSTALLATION

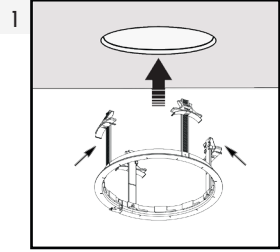

Push the Zip-Clip™ rails inwards from the top, just enough, so they fit through the ceiling hole opening, then **INSERT THE BAYONET RING INTO THE CUT-OUT** hole within the ceiling surface.

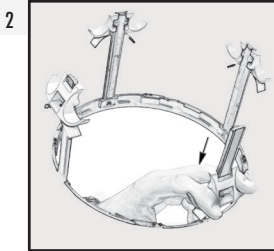

Reach through and **PLACE 2 FINGERS ON THE GROOVES** of the Bayonet Zip-Clip™ to pull each Zip-Clip™ down the rail.

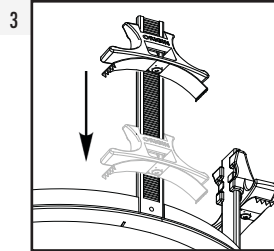

PULL DOWN on all 4 Bayonet Zip-Clips™ to lower them along the Bayonet rails.

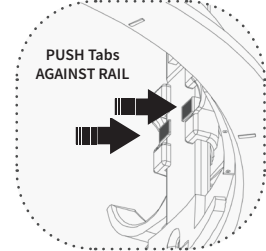

Note: If the Bayonet Zip-Clips™ need to be adjusted or removed, depress the metal tabs along the rail and push up.

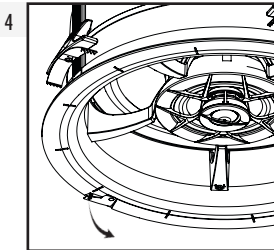

After connecting wires, insert the Speaker into the Bayonet Ring, with the **METAL LOCK TAB LIFTED AWAY FROM THE RING.**

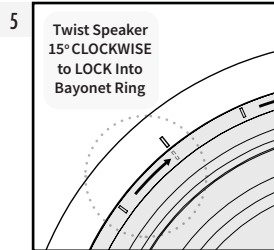

TWIST THE SPEAKER 15° CLOCKWISE, until the indicators on both the Bayonet Ring & the Speaker are aligned.

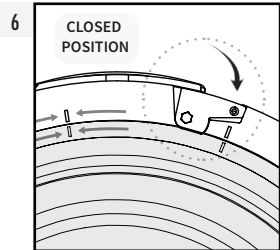

CLOSED POSITION: To finalize the installation, **PUSH THE METAL LOCK TAB TOWARDS** the Bayonet Ring.

Note: Grille may not sit flush until this Lock is properly engaged.